

REVISIONS	
STREETS WING EXPANSION	03/16/2016
1 ADDENDUM NO. 1	03/25/2016
2 ADDENDUM NO. 2	05/11/2016
4 ADDENDUM NO. 4	07/21/2016

CLIENT INFORMATION  
**CITY OF SUFFOLK,  
 VIRGINIA**

440 MARKET STREET, SUFFOLK, VIRGINIA 23434

800 CAROLINA ROAD,  
 SUFFOLK, VIRGINIA 23434

DEPARTMENT OF PUBLIC  
 WORKS OPERATION  
 COMPLEX

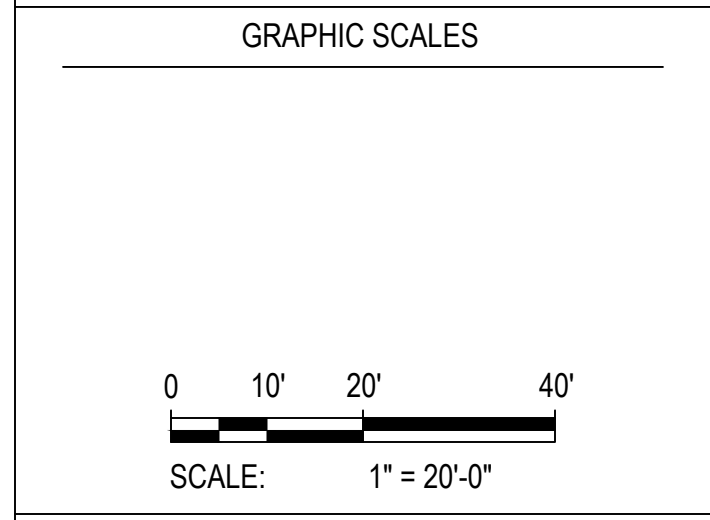
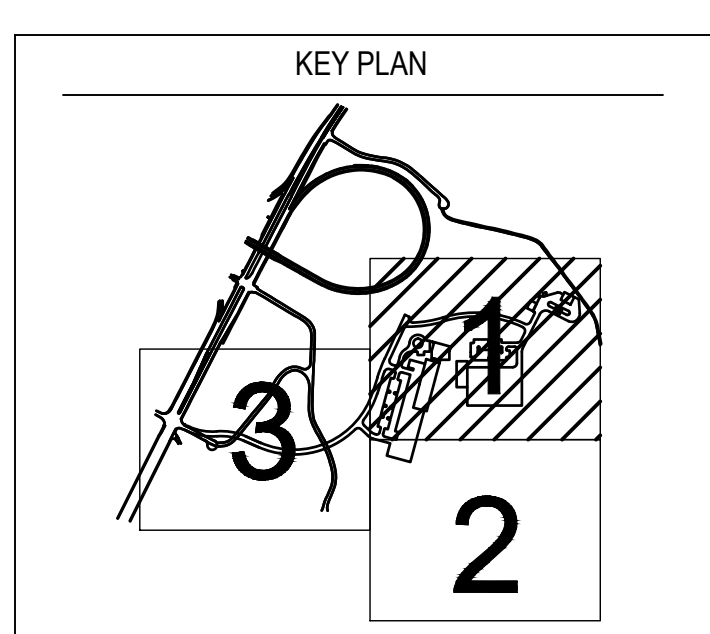

SIGNATURE

SITE & UTILITY  
 PLAN  
 Drawing No.  
**C301A**

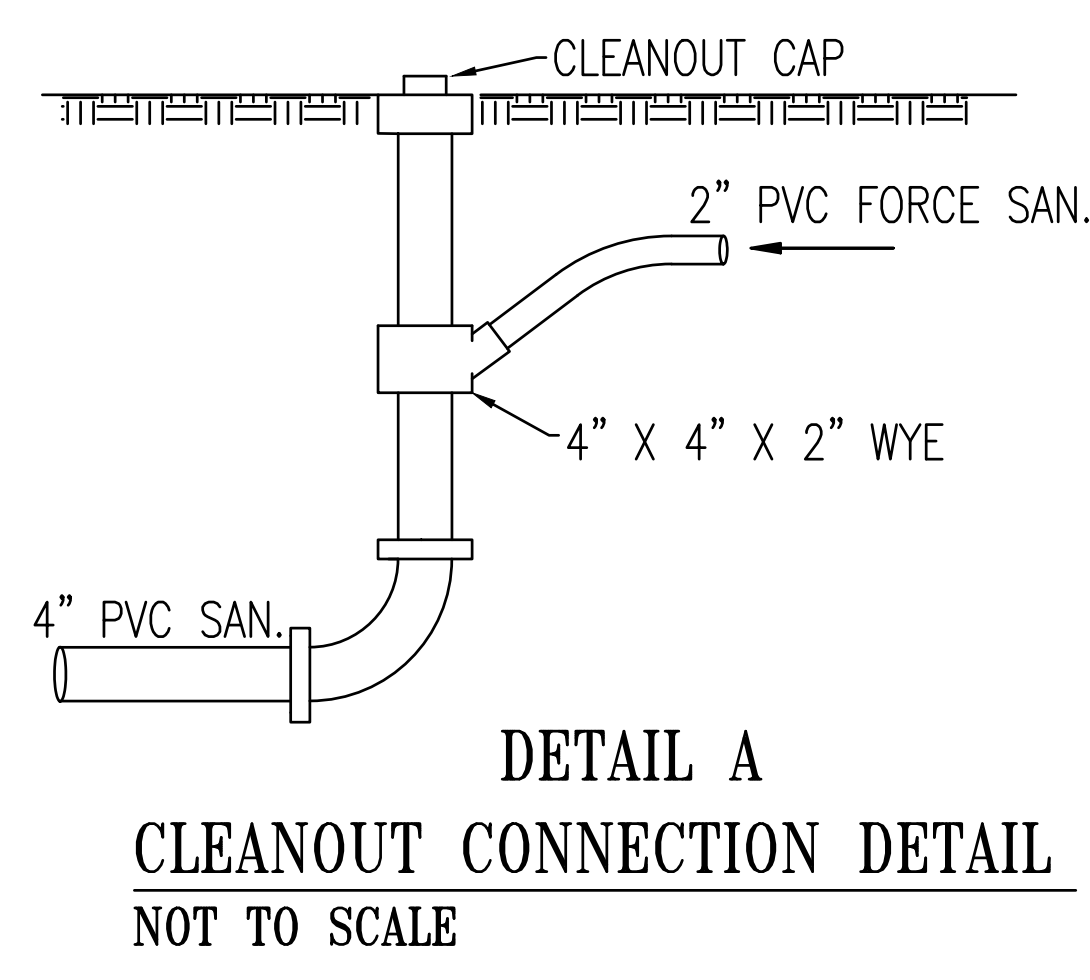
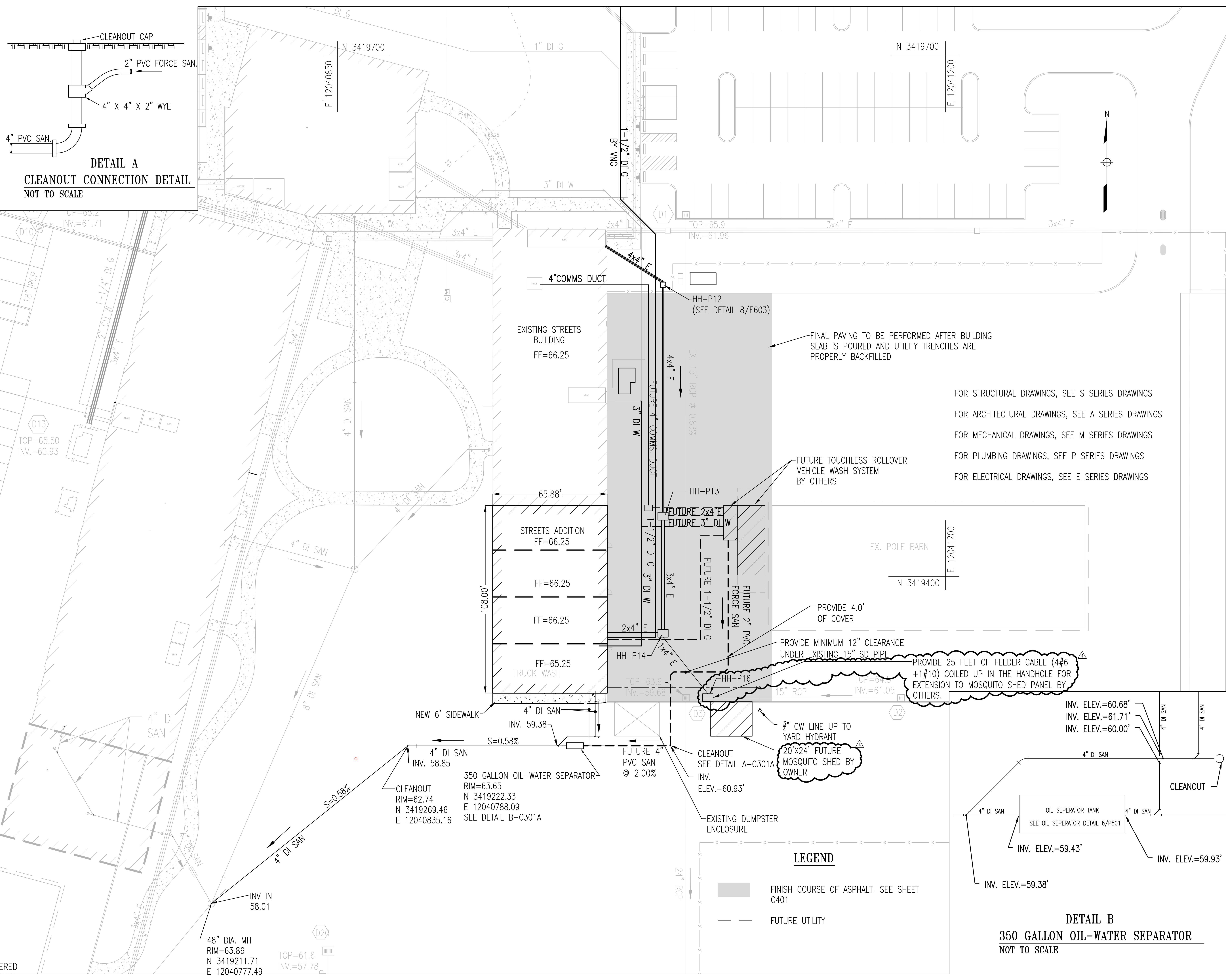

FOR STRUCTURAL DRAWINGS, SEE S SERIES DRAWINGS  
 FOR ARCHITECTURAL DRAWINGS, SEE A SERIES DRAWINGS  
 FOR MECHANICAL DRAWINGS, SEE M SERIES DRAWINGS  
 FOR PLUMBING DRAWINGS, SEE P SERIES DRAWINGS  
 FOR ELECTRICAL DRAWINGS, SEE E SERIES DRAWINGS

FINAL PAVING TO BE PERFORMED AFTER BUILDING SLAB IS POURED AND UTILITY TRENCHES ARE PROPERLY BACKFILLED

FUTURE TOUCHLESS ROLLOVER VEHICLE WASH SYSTEM BY OTHERS

PROVIDE 4.0' OF COVER  
 PROVIDE MINIMUM 12" CLEARANCE UNDER EXISTING 15" SD PIPE

PROVIDE 25 FEET OF FEEDER CABLE (4#6 +1#10) COILED UP IN THE HANDHOLE FOR EXTENSION TO MOSQUITO SHED PANEL BY OTHERS.

20'x24' FUTURE MOSQUITO SHED BY OWNER

CLEANOUT SEE DETAIL A-C301A

**LEGEND**

- FINISH COURSE OF ASPHALT. SEE SHEET C401
- FUTURE UTILITY

**DETAIL B  
 350 GALLON OIL-WATER SEPARATOR  
 NOT TO SCALE**

350 GALLON OIL-WATER SEPARATOR  
 RIM=63.65  
 N 3419222.33  
 E 12040788.09  
 SEE DETAIL B-C301A

48" DIA. MH  
 RIM=63.86  
 N 3419211.71  
 E 12040777.49

TOP=61.6  
 INV.=57.78

ERED

FILENAME: N:\12222-000\CONSTRUCTION FILES FOR CONSTRUCTION ADMIN\20160623\14.DWG  
 PLOT DATE: 7/22/2016 8:58:40 AM PAPER SETUP: PLOT STYLE: HPGL\_2000.ctb PAPER SIZE: ARCH (FULL) PLOT DEVICE: HPGL\_PLOTTER