

MAINTENANCE BUILDING SITE PREPARATION SUFFOLK EXECUTIVE AIRPORT SUFFOLK, VIRGINIA



TBI PROJECT NO. 3814-1703
SITE PLAN SPL2018-00019

BMP RECAP SHEET
prepared for
CITY OF SUFFOLK

JUNE 2018



LOCATION MAP
SCALE: 1"=2,000'

PROJECT INFORMATION		PROJECT PROPERTY IDENTIFICATION	
CITY OF SUFFOLK	PROJECT NO. 3814-1703	PROJECT NO. 3814-1703	PROJECT NO. 3814-1703
PROJECT NO. 3814-1703	PROJECT NO. 3814-1703	PROJECT NO. 3814-1703	PROJECT NO. 3814-1703
PROJECT NO. 3814-1703	PROJECT NO. 3814-1703	PROJECT NO. 3814-1703	PROJECT NO. 3814-1703
PROJECT NO. 3814-1703	PROJECT NO. 3814-1703	PROJECT NO. 3814-1703	PROJECT NO. 3814-1703

BLANKING CODE & DEVELOPMENT STANDARDS
 ALL DEVELOPMENT SHALL BE IN ACCORDANCE WITH THE CURRENT CODES AND ORDINANCES OF THE CITY OF SUFFOLK, INCLUDING BUT NOT LIMITED TO THE FOLLOWING:
 WATER PLANNING DATA
 SEWER PLANNING DATA

SHEET INDEX	
NO.	TITLE
1	COVER SHEET
2	GENERAL LAYOUT & PROPERTY LINES
3	CONSTRUCTION PLAN
4	SITE PLAN
5	PROPOSED IMPROVEMENTS PLAN
6	PROPOSED CONSTRUCTION NOTES & DETAILS
7	PROPOSED UTILITIES & SERVICES LOCUS
8	PROPOSED UTILITIES & SERVICES LOCUS
9	PROPOSED UTILITIES & SERVICES LOCUS

TALBERT & BRIGHT
 ENGINEERING & PLANNING CONSULTANTS
 1000 EAST BROAD STREET, SUITE 100
 CHARLOTTE, NORTH CAROLINA 28202
 PHONE: 704.375.1111 FAX: 704.375.1112

RESPONSIBLE LAND DISTURBER DESIGNATION
 THE CONTRACTOR SHALL SUBMIT THE REQUIRED AND INFORMATION TO THE CITY OF SUFFOLK DEPARTMENT OF PUBLIC WORKS AT (757) 514-5283 FOR FIELD REVIEW.

DEVELOPER NOTE
 THE DEVELOPER SHALL BE RESPONSIBLE FOR THE REMOVAL OF ALL EXISTING UTILITIES AND STRUCTURES FROM THE PROJECT SITE. THE CITY OF SUFFOLK DEPARTMENT OF PUBLIC WORKS SHALL BE CONTACTED FOR ANY INFORMATION REGARDING THE REMOVAL OF UTILITIES AND STRUCTURES FROM THE PROJECT SITE.

FLOOD ZONE INFORMATION
 APPROXIMATE FLOOD ZONE INFORMATION IS SHOWN ON THE ATTACHED FLOOD ZONE MAP. THE FLOOD ZONE MAP IS A GENERAL REPRESENTATION AND DOES NOT CONSTITUTE A GUARANTEE OF ACCURACY. THE CITY OF SUFFOLK DEPARTMENT OF PUBLIC WORKS SHALL BE CONTACTED FOR ANY INFORMATION REGARDING THE FLOOD ZONE MAP.

PROJECT SOIL TYPES
 1. UNDESIGNED PINE SANDY LOAM
 2. UNDESIGNED PINE SANDY LOAM
 3. UNDESIGNED PINE SANDY LOAM
 4. UNDESIGNED PINE SANDY LOAM

STORMWATER QUALITY REQUIREMENTS
 THE PROJECT IS LOCATED WITHIN THE CITY OF SUFFOLK. THE PROJECT IS SUBJECT TO THE CITY OF SUFFOLK STORMWATER QUALITY REQUIREMENTS. THE PROJECT IS SUBJECT TO THE CITY OF SUFFOLK STORMWATER QUALITY REQUIREMENTS. THE PROJECT IS SUBJECT TO THE CITY OF SUFFOLK STORMWATER QUALITY REQUIREMENTS.

STORMWATER QUANTITY NOTE
 ALL STORMWATER FROM THE PROPOSED DEVELOPMENT SHALL BE STORED ON-SITE UNTIL IT CAN BE DISCHARGED TO THE CITY OF SUFFOLK STORMWATER SYSTEM. THE PROJECT IS SUBJECT TO THE CITY OF SUFFOLK STORMWATER QUANTITY REQUIREMENTS. THE PROJECT IS SUBJECT TO THE CITY OF SUFFOLK STORMWATER QUANTITY REQUIREMENTS.

ENVIRONMENTAL NOTES
 1. A PORTION OF THE PROJECT'S EXISTING ADJACENT IS LOCATED WITHIN A CENSUS-BASED MAP 1 COVERED DISTRICT AND IS IDENTIFIED AS A RESOURCE. THE PROJECT IS SUBJECT TO THE CITY OF SUFFOLK ENVIRONMENTAL REQUIREMENTS. THE PROJECT IS SUBJECT TO THE CITY OF SUFFOLK ENVIRONMENTAL REQUIREMENTS.

COVER SHEET
 Maintenance Building Site Preparation
 Suffolk Executive Airport - Suffolk, Virginia

DATE: _____ SET NO.: _____
 DATE: _____

DIRECTOR OF PLANNING, CITY OF SUFFOLK

DATE	12/11/93
BY	...
CHECKED	...
APPROVED	...
PROJECT NO.	...
SHEET NO.	...

GENERAL LAYOUT & PHASING PLAN
 Maintenance Building Site Preparation
 Suffolk Executive Airport - Suffolk, Virginia

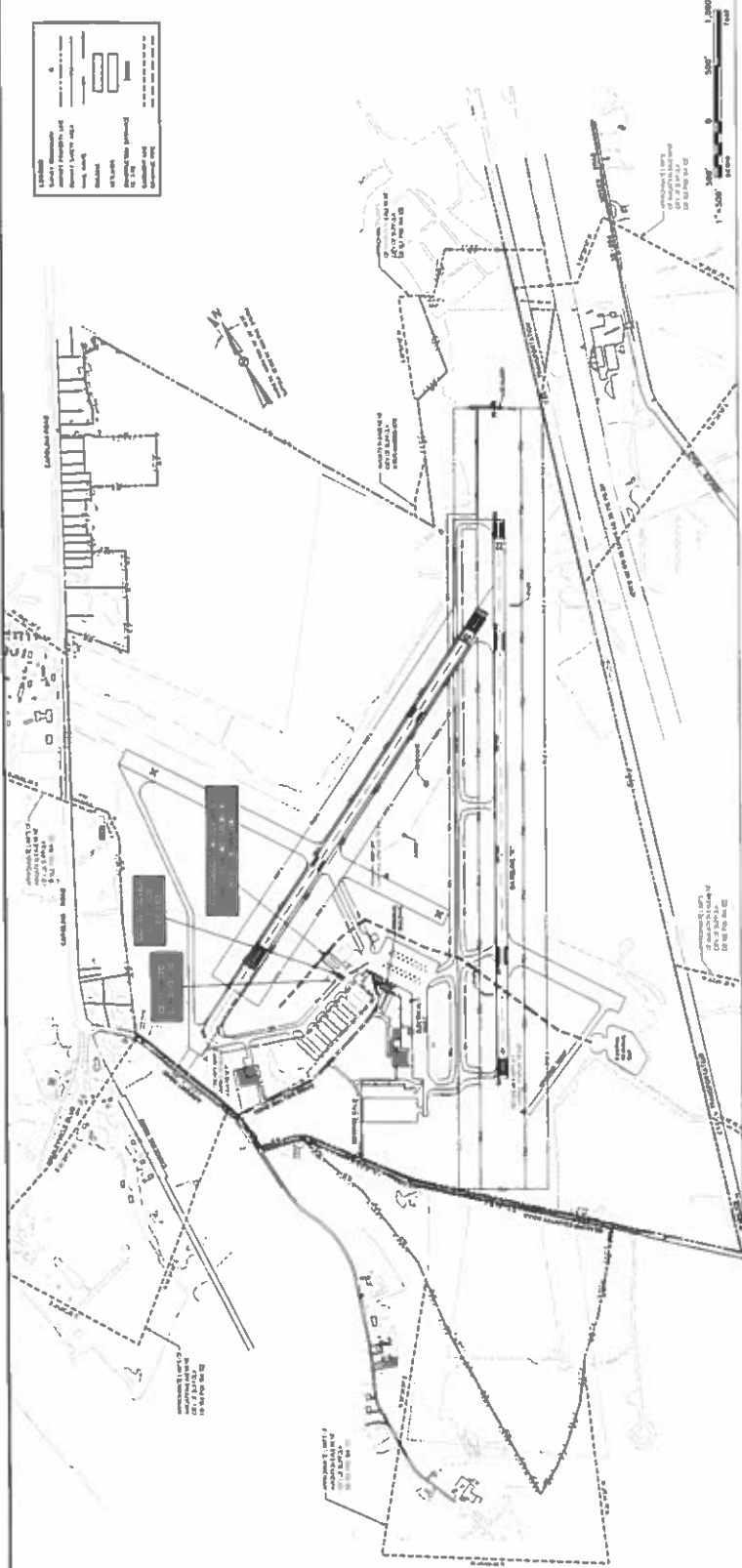

ADJACENT PROPERTY OWNER TABLE

OWNER NAME	ADDRESS	PHONE	NOTES
...
...
...

BENCHMARK DATA

BM 1 - CONCRETE CONTROL	115.000
BM 2 - CONCRETE CONTROL	115.000
BM 3 - CONCRETE CONTROL	115.000
BM 4 - CONCRETE CONTROL	115.000
BM 5 - CONCRETE CONTROL	115.000
BM 6 - CONCRETE CONTROL	115.000
BM 7 - CONCRETE CONTROL	115.000
BM 8 - CONCRETE CONTROL	115.000
BM 9 - CONCRETE CONTROL	115.000
BM 10 - CONCRETE CONTROL	115.000

REMARKS

1. The contractor shall be responsible for obtaining all necessary permits and approvals for the construction of the maintenance building and site preparation. The contractor shall be responsible for obtaining all necessary permits and approvals for the construction of the maintenance building and site preparation.

2. The contractor shall be responsible for obtaining all necessary permits and approvals for the construction of the maintenance building and site preparation. The contractor shall be responsible for obtaining all necessary permits and approvals for the construction of the maintenance building and site preparation.

3. The contractor shall be responsible for obtaining all necessary permits and approvals for the construction of the maintenance building and site preparation. The contractor shall be responsible for obtaining all necessary permits and approvals for the construction of the maintenance building and site preparation.

PROJECT DESCRIPTION

The project consists of the construction of a maintenance building and site preparation at the Suffolk Executive Airport. The project includes the construction of a maintenance building and site preparation.

PHASING NOTES

The construction shall be completed in three phases. Phase 1 includes the construction of the maintenance building and site preparation. Phase 2 includes the construction of the maintenance building and site preparation. Phase 3 includes the construction of the maintenance building and site preparation.

SAFETY PLAN NOTES

The contractor shall be responsible for implementing a safety plan for the construction of the maintenance building and site preparation. The contractor shall be responsible for implementing a safety plan for the construction of the maintenance building and site preparation.

The contractor shall be responsible for implementing a safety plan for the construction of the maintenance building and site preparation. The contractor shall be responsible for implementing a safety plan for the construction of the maintenance building and site preparation.

GENERAL NOTES

1. The contractor shall be responsible for obtaining all necessary permits and approvals for the construction of the maintenance building and site preparation. The contractor shall be responsible for obtaining all necessary permits and approvals for the construction of the maintenance building and site preparation.

2. The contractor shall be responsible for obtaining all necessary permits and approvals for the construction of the maintenance building and site preparation. The contractor shall be responsible for obtaining all necessary permits and approvals for the construction of the maintenance building and site preparation.

ADDITIONAL NOTES

The contractor shall be responsible for obtaining all necessary permits and approvals for the construction of the maintenance building and site preparation. The contractor shall be responsible for obtaining all necessary permits and approvals for the construction of the maintenance building and site preparation.

GENERAL NOTES

1. The contractor shall be responsible for obtaining all necessary permits and approvals for the construction of the maintenance building and site preparation. The contractor shall be responsible for obtaining all necessary permits and approvals for the construction of the maintenance building and site preparation.

2. The contractor shall be responsible for obtaining all necessary permits and approvals for the construction of the maintenance building and site preparation. The contractor shall be responsible for obtaining all necessary permits and approvals for the construction of the maintenance building and site preparation.

GENERAL NOTES

3. The contractor shall be responsible for obtaining all necessary permits and approvals for the construction of the maintenance building and site preparation. The contractor shall be responsible for obtaining all necessary permits and approvals for the construction of the maintenance building and site preparation.

4. The contractor shall be responsible for obtaining all necessary permits and approvals for the construction of the maintenance building and site preparation. The contractor shall be responsible for obtaining all necessary permits and approvals for the construction of the maintenance building and site preparation.

GENERAL NOTES

5. The contractor shall be responsible for obtaining all necessary permits and approvals for the construction of the maintenance building and site preparation. The contractor shall be responsible for obtaining all necessary permits and approvals for the construction of the maintenance building and site preparation.

6. The contractor shall be responsible for obtaining all necessary permits and approvals for the construction of the maintenance building and site preparation. The contractor shall be responsible for obtaining all necessary permits and approvals for the construction of the maintenance building and site preparation.



Project No.	34119
Client	SAIC
Scale	AS SHOWN
Date	12/15/11
Drawn	CB
Checked	CB
Project	34119
Sheet	3

LEGEND

EXISTING PAVEMENT	EXISTING CONCRETE
EXISTING ASPHALT	EXISTING GRAVEL
EXISTING GRAVEL	EXISTING SAND
EXISTING SAND	EXISTING SOIL
EXISTING SOIL	EXISTING UTILITIES
EXISTING UTILITIES	EXISTING FOUNDATION
EXISTING FOUNDATION	EXISTING STRUCTURE
EXISTING STRUCTURE	EXISTING ROOF
EXISTING ROOF	EXISTING INTERIOR
EXISTING INTERIOR	EXISTING EXTERIOR
EXISTING EXTERIOR	EXISTING CURB
EXISTING CURB	EXISTING DRIVEWAY
EXISTING DRIVEWAY	EXISTING SIDEWALK
EXISTING SIDEWALK	EXISTING FENCE
EXISTING FENCE	EXISTING SIGN
EXISTING SIGN	EXISTING LIGHT
EXISTING LIGHT	EXISTING TREE
EXISTING TREE	EXISTING BUSH
EXISTING BUSH	EXISTING GRASS
EXISTING GRASS	EXISTING PAVEMENT

GENERAL NOTES

- THE LOCATION OF UNDERGROUND UTILITIES AS INDICATED ON THE PLAN HAS BEEN VERIFIED BY FIELD SURVEY AND SHALL BE MAINTAINED THROUGHOUT THE DEMOLITION PROCESS. THE CONTRACTOR SHALL BE RESPONSIBLE FOR THE PROTECTION OF ALL UTILITIES. IF ANY UTILITIES ARE DAMAGED OR DISRUPTED, THE CONTRACTOR SHALL BE RESPONSIBLE FOR THE REPAIR AND RESTORATION OF THE UTILITIES TO ORIGINAL OR BETTER CONDITION. THE CONTRACTOR SHALL BE RESPONSIBLE FOR THE PROTECTION OF ALL UTILITIES PRIOR TO THE DEMOLITION OF THE BUILDING. THE CONTRACTOR SHALL BE RESPONSIBLE FOR THE PROTECTION OF ALL UTILITIES PRIOR TO THE DEMOLITION OF THE BUILDING. THE CONTRACTOR SHALL BE RESPONSIBLE FOR THE PROTECTION OF ALL UTILITIES PRIOR TO THE DEMOLITION OF THE BUILDING.

GENERAL NOTES

- THE CONTRACTOR SHALL BE RESPONSIBLE FOR LOCATING AND PROTECTING ALL EXISTING UTILITIES AND FACILITIES FROM DAMAGE BY THE DEMOLITION PROCESS. THE CONTRACTOR SHALL BE RESPONSIBLE FOR THE PROTECTION OF ALL UTILITIES PRIOR TO THE DEMOLITION OF THE BUILDING. THE CONTRACTOR SHALL BE RESPONSIBLE FOR THE PROTECTION OF ALL UTILITIES PRIOR TO THE DEMOLITION OF THE BUILDING. THE CONTRACTOR SHALL BE RESPONSIBLE FOR THE PROTECTION OF ALL UTILITIES PRIOR TO THE DEMOLITION OF THE BUILDING.

DESIGN PROFESSIONAL'S CERTIFICATE

I, the undersigned, being a duly Licensed Professional Engineer in the State of Virginia, do hereby certify that I am the author of the design and that the design complies with the provisions of the Code of Ordinances of the City of Suffolk, Virginia, and the provisions of the Code of Ordinances of the State of Virginia.

Signature: Charles C. Talbert
 License No. 34119
 State of Virginia
 Mechanical Engineering

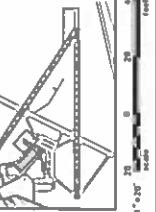

DEMOLITION NOTES

- THE CONTRACTOR SHALL BE RESPONSIBLE FOR REMOVING AND DISPOSING OF ALL EXISTING UTILITIES AND FACILITIES FROM THE DEMOLITION SITE. THE CONTRACTOR SHALL BE RESPONSIBLE FOR THE PROTECTION OF ALL UTILITIES PRIOR TO THE DEMOLITION OF THE BUILDING. THE CONTRACTOR SHALL BE RESPONSIBLE FOR THE PROTECTION OF ALL UTILITIES PRIOR TO THE DEMOLITION OF THE BUILDING. THE CONTRACTOR SHALL BE RESPONSIBLE FOR THE PROTECTION OF ALL UTILITIES PRIOR TO THE DEMOLITION OF THE BUILDING.

DEMOLITION NOTES

- THE CONTRACTOR SHALL BE RESPONSIBLE FOR REMOVING AND DISPOSING OF ALL EXISTING UTILITIES AND FACILITIES FROM THE DEMOLITION SITE. THE CONTRACTOR SHALL BE RESPONSIBLE FOR THE PROTECTION OF ALL UTILITIES PRIOR TO THE DEMOLITION OF THE BUILDING. THE CONTRACTOR SHALL BE RESPONSIBLE FOR THE PROTECTION OF ALL UTILITIES PRIOR TO THE DEMOLITION OF THE BUILDING. THE CONTRACTOR SHALL BE RESPONSIBLE FOR THE PROTECTION OF ALL UTILITIES PRIOR TO THE DEMOLITION OF THE BUILDING.

DEMOLITION NOTES

- THE CONTRACTOR SHALL BE RESPONSIBLE FOR REMOVING AND DISPOSING OF ALL EXISTING UTILITIES AND FACILITIES FROM THE DEMOLITION SITE. THE CONTRACTOR SHALL BE RESPONSIBLE FOR THE PROTECTION OF ALL UTILITIES PRIOR TO THE DEMOLITION OF THE BUILDING. THE CONTRACTOR SHALL BE RESPONSIBLE FOR THE PROTECTION OF ALL UTILITIES PRIOR TO THE DEMOLITION OF THE BUILDING. THE CONTRACTOR SHALL BE RESPONSIBLE FOR THE PROTECTION OF ALL UTILITIES PRIOR TO THE DEMOLITION OF THE BUILDING.

DEMOLITION NOTES

- THE CONTRACTOR SHALL BE RESPONSIBLE FOR REMOVING AND DISPOSING OF ALL EXISTING UTILITIES AND FACILITIES FROM THE DEMOLITION SITE. THE CONTRACTOR SHALL BE RESPONSIBLE FOR THE PROTECTION OF ALL UTILITIES PRIOR TO THE DEMOLITION OF THE BUILDING. THE CONTRACTOR SHALL BE RESPONSIBLE FOR THE PROTECTION OF ALL UTILITIES PRIOR TO THE DEMOLITION OF THE BUILDING. THE CONTRACTOR SHALL BE RESPONSIBLE FOR THE PROTECTION OF ALL UTILITIES PRIOR TO THE DEMOLITION OF THE BUILDING.

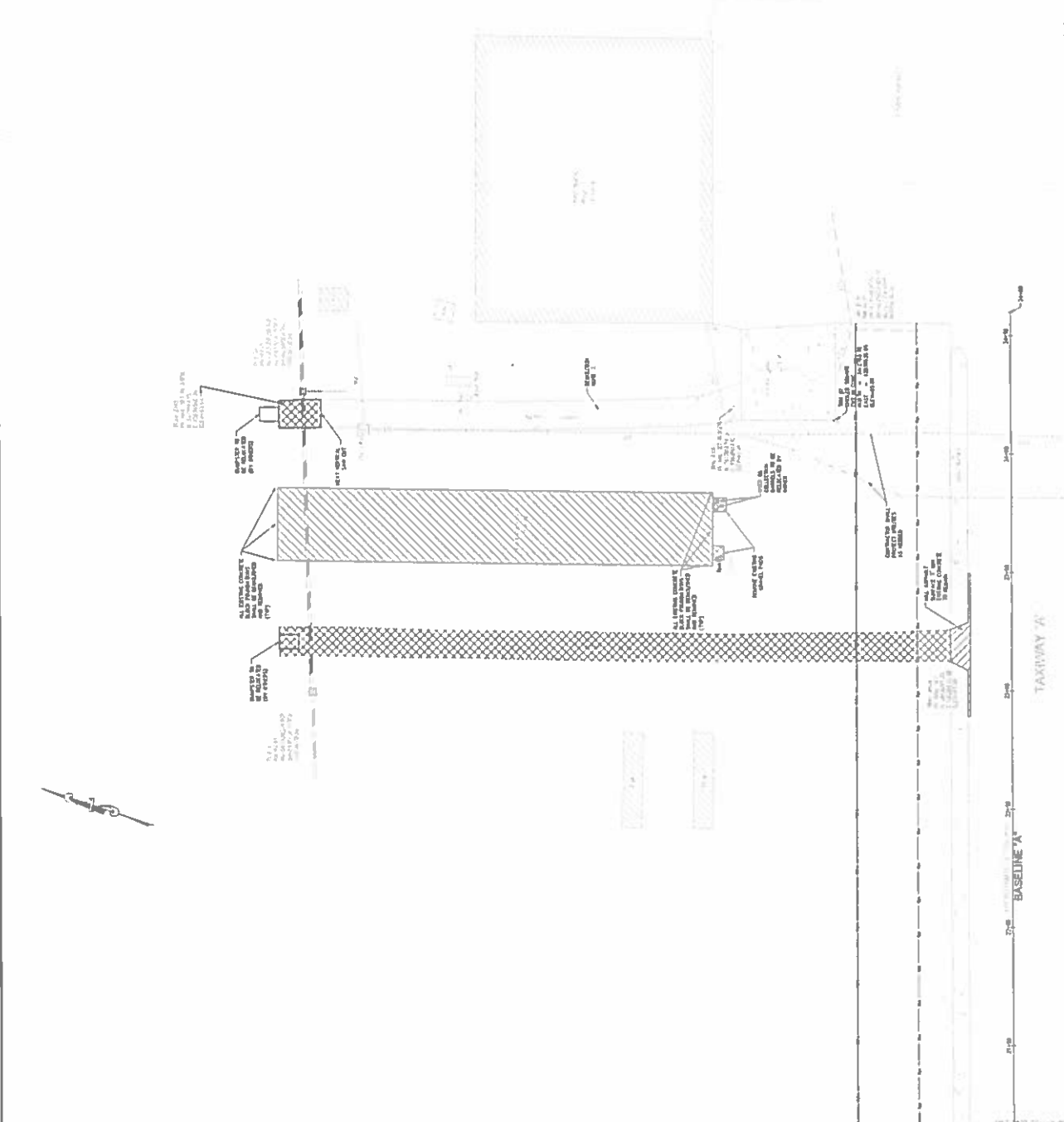

UTILITY NOTES

1. THE CITY OF BATON Rouge CONSTRUCTION MANAGER FOR UTILITY INSTALLATIONS SHALL BE MR. DEAN ADAMS (504) 381-7029.
2. WATER AND SEWER INSTALLATIONS SHALL BE THE RESPONSIBILITY OF THE CITY OF BATON Rouge. UTILITIES SHALL BE AVAILABLE FOR INSPECTION ON THE CITY WEBSITE.
3. THE CONTRACTOR IS RESPONSIBLE FOR OBTAINING ALL NECESSARY PERMITS AND APPROVALS FROM THE CITY OF BATON Rouge BEFORE ANY CONSTRUCTION BEGINS. THE CONTRACTOR SHALL BE RESPONSIBLE FOR OBTAINING ALL NECESSARY PERMITS AND APPROVALS FROM THE CITY OF BATON Rouge BEFORE ANY CONSTRUCTION BEGINS.
4. ALL EXISTING UTILITIES SHALL REMAIN IN PLACE UNLESS OTHERWISE NOTED ON THE PLANS. THE CONTRACTOR SHALL BE RESPONSIBLE FOR VERIFYING THE LOCATION AND DEPTH OF ALL EXISTING UTILITIES BEFORE ANY CONSTRUCTION BEGINS.
5. THE CONTRACTOR SHALL BE RESPONSIBLE FOR PROTECTING ALL EXISTING UTILITIES AND STRUCTURES FROM DAMAGE. THE CONTRACTOR SHALL BE RESPONSIBLE FOR REPAIRING ANY DAMAGE TO EXISTING UTILITIES AND STRUCTURES.
6. THE CONTRACTOR SHALL BE RESPONSIBLE FOR OBTAINING ALL NECESSARY PERMITS AND APPROVALS FROM THE CITY OF BATON Rouge BEFORE ANY CONSTRUCTION BEGINS.
7. THE CONTRACTOR SHALL BE RESPONSIBLE FOR OBTAINING ALL NECESSARY PERMITS AND APPROVALS FROM THE CITY OF BATON Rouge BEFORE ANY CONSTRUCTION BEGINS.
8. THE CONTRACTOR SHALL BE RESPONSIBLE FOR OBTAINING ALL NECESSARY PERMITS AND APPROVALS FROM THE CITY OF BATON Rouge BEFORE ANY CONSTRUCTION BEGINS.

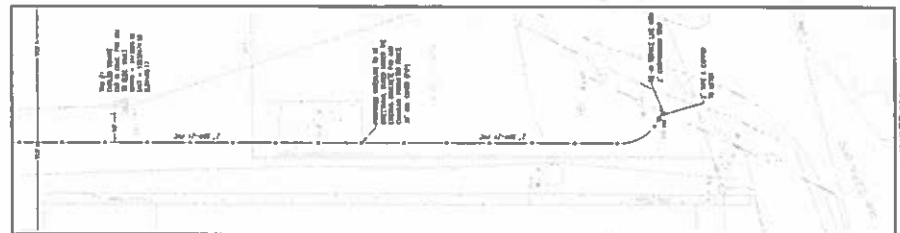
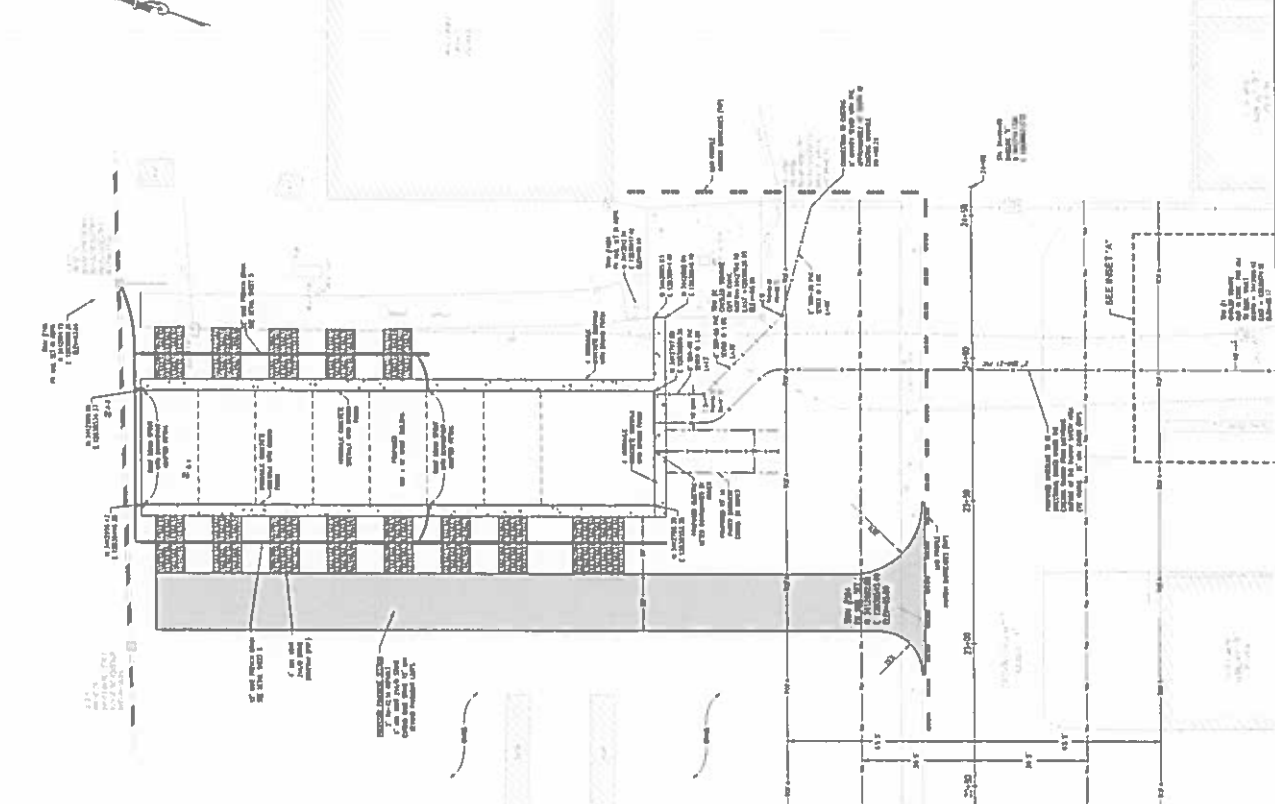

LEGEND

DESCRIPTION	SYMBOL
EXISTING UTILITY	(Symbol)
NEW UTILITY	(Symbol)
PROTECT EXISTING UTILITY	(Symbol)
CONSTRUCTION OF NEW UTILITY	(Symbol)
CONNECTION OF EXISTING UTILITY	(Symbol)
UTILITY CROSSING	(Symbol)
UTILITY UNDERPASS	(Symbol)
UTILITY OVERPASS	(Symbol)
UTILITY TRENCH	(Symbol)
UTILITY MANHOLE	(Symbol)
UTILITY VALVE	(Symbol)
UTILITY METER	(Symbol)
UTILITY SERVICE LINE	(Symbol)
UTILITY MAIN LINE	(Symbol)
UTILITY BRANCH LINE	(Symbol)
UTILITY TIE IN	(Symbol)
UTILITY CROSSING	(Symbol)
UTILITY UNDERPASS	(Symbol)
UTILITY OVERPASS	(Symbol)
UTILITY TRENCH	(Symbol)
UTILITY MANHOLE	(Symbol)
UTILITY VALVE	(Symbol)
UTILITY METER	(Symbol)
UTILITY SERVICE LINE	(Symbol)
UTILITY MAIN LINE	(Symbol)
UTILITY BRANCH LINE	(Symbol)
UTILITY TIE IN	(Symbol)

TALBERT & BRIGHT
 ENGINEERS & ARCHITECTS
 1309 KENNEDY ROAD, SUITE 110
 BATON ROUGE, LOUISIANA 70801
 PHONE: (504) 763-1000
 FAX: (504) 763-1001

REVISIONS

NO.	DATE	DESCRIPTION
1	12/10/20 </td <td>ISSUE FOR PERMITTING</td>	ISSUE FOR PERMITTING
2	12/10/20	ISSUE FOR PERMITTING
3	12/10/20	ISSUE FOR PERMITTING
4	12/10/20	ISSUE FOR PERMITTING
5	12/10/20	ISSUE FOR PERMITTING
6	12/10/20	ISSUE FOR PERMITTING
7	12/10/20	ISSUE FOR PERMITTING
8	12/10/20	ISSUE FOR PERMITTING
9	12/10/20	ISSUE FOR PERMITTING
10	12/10/20	ISSUE FOR PERMITTING
11	12/10/20	ISSUE FOR PERMITTING
12	12/10/20	ISSUE FOR PERMITTING
13	12/10/20	ISSUE FOR PERMITTING
14	12/10/20	ISSUE FOR PERMITTING
15	12/10/20	ISSUE FOR PERMITTING
16	12/10/20	ISSUE FOR PERMITTING
17	12/10/20	ISSUE FOR PERMITTING
18	12/10/20	ISSUE FOR PERMITTING
19	12/10/20	ISSUE FOR PERMITTING
20	12/10/20	ISSUE FOR PERMITTING
21	12/10/20	ISSUE FOR PERMITTING
22	12/10/20	ISSUE FOR PERMITTING
23	12/10/20	ISSUE FOR PERMITTING
24	12/10/20	ISSUE FOR PERMITTING
25	12/10/20	ISSUE FOR PERMITTING
26	12/10/20	ISSUE FOR PERMITTING
27	12/10/20	ISSUE FOR PERMITTING
28	12/10/20	ISSUE FOR PERMITTING
29	12/10/20	ISSUE FOR PERMITTING
30	12/10/20	ISSUE FOR PERMITTING
31	12/10/20	ISSUE FOR PERMITTING
32	12/10/20	ISSUE FOR PERMITTING
33	12/10/20	ISSUE FOR PERMITTING
34	12/10/20	ISSUE FOR PERMITTING
35	12/10/20	ISSUE FOR PERMITTING
36	12/10/20	ISSUE FOR PERMITTING
37	12/10/20	ISSUE FOR PERMITTING
38	12/10/20	ISSUE FOR PERMITTING
39	12/10/20	ISSUE FOR PERMITTING
40	12/10/20	ISSUE FOR PERMITTING
41	12/10/20	ISSUE FOR PERMITTING
42	12/10/20	ISSUE FOR PERMITTING
43	12/10/20	ISSUE FOR PERMITTING
44	12/10/20	ISSUE FOR PERMITTING
45	12/10/20	ISSUE FOR PERMITTING
46	12/10/20	ISSUE FOR PERMITTING
47	12/10/20	ISSUE FOR PERMITTING
48	12/10/20	ISSUE FOR PERMITTING
49	12/10/20	ISSUE FOR PERMITTING
50	12/10/20	ISSUE FOR PERMITTING

SITE PLAN
 Maintenance Building Site Preparation
 Suffolk Executive Airport - Suffolk, Virginia

PROFESSIONAL SEAL

DATE: JUNE 2020
 SCALE: 1" = 100'

PROJECT NO.: 2019-1193
 SHEET NO.: 4 OF 8

DESIGNED BY: [Signature]
 CHECKED BY: [Signature]
 DRAWN BY: [Signature]

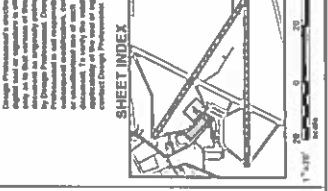

Design Professional's involvement or approval is required for all utility work. The Contractor shall be responsible for obtaining all necessary permits and approvals from the City of Baton Rouge. The Contractor shall be responsible for protecting all existing utilities and structures from damage. The Contractor shall be responsible for repairing any damage to existing utilities and structures. The Contractor shall be responsible for obtaining all necessary permits and approvals from the City of Baton Rouge before any construction begins. The Contractor shall be responsible for obtaining all necessary permits and approvals from the City of Baton Rouge before any construction begins.

G. B. JONES
Professional Engineer
License No. 46065
State of Virginia

NO.	DATE	REVISION

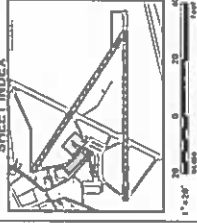

- #### CONTRACTOR NOTES:
- ALL DRAINAGE INSTALLATIONS TO BE IN ACCORDANCE TO WEST VIRGINIA CHAPTER 22-10A, R.C.M.C.
 - DRAINAGE AREAS FOR PROPOSED GRADING CONNECTIONS TO BE SHOWN ON PDC SCHEDULE 40 PIPE.

- #### GENERAL NOTES:
- CONTRACTOR SHALL COORDINATE ALL ACCESS AND EGRESS FACILITIES WITH THE AIRPORT MANAGER.
 - THE CONTRACTOR SHALL BE RESPONSIBLE FOR PROTECTING ALL UTILITIES AND SERVICES TO REMAIN ON SITE. ALL UTILITIES SHALL BE IDENTIFIED BY THE CONTRACTOR AND PROTECTED BY INSTALLING AND MAINTAINING ALL APPROPRIATE SHIELDING AND PROTECTIVE STRUCTURES THROUGHOUT THE CONSTRUCTION PERIOD.
 - ANY KNOWN UTILITIES OR FACILITIES DAMAGED DURING THE PROJECT BY THE CONTRACTOR SHALL BE REPAIRED TO ORIGINAL CONDITIONS. THE CONTRACTOR SHALL BE RESPONSIBLE FOR PROTECTING EXISTING UTILITIES FROM DAMAGE DURING THE PROJECT.
 - THE CONTRACTOR SHALL CONTACT THE UTILITIES COMPANY AT THE START OF CONSTRUCTION TO LOCATE ALL UTILITIES AND IDENTIFY THE EXISTING UTILITIES. THE CONTRACTOR SHALL BE RESPONSIBLE FOR MARKING AND PROTECTING ALL UTILITIES TO REMAIN ON SITE.
 - THE CONTRACTOR SHALL BE RESPONSIBLE FOR PROTECTING ALL EXISTING UTILITIES AND SERVICES TO REMAIN ON SITE. ALL UTILITIES SHALL BE IDENTIFIED BY THE CONTRACTOR AND PROTECTED BY INSTALLING AND MAINTAINING ALL APPROPRIATE SHIELDING AND PROTECTIVE STRUCTURES THROUGHOUT THE CONSTRUCTION PERIOD.

LEGEND

SYMBOL	DESCRIPTION
	CONCRETE
	ASPHALT
	GRAVEL
	COMPACTED SOIL
	RIPPRAP
	DRAINAGE PIPE
	CATCH BASIN
	STORM SEWER
	SANITARY SEWER
	WATER MAIN
	GAS LINE
	ELECTRICAL LINE
	TELEPHONE LINE
	FIRE HYDRANT
	UTILITY VAULT
	CATCHMENT AREA
	DRAINAGE AREA
	STORM WATER POND
	RETENTION POND
	EXISTING STRUCTURE
	PROPOSED STRUCTURE

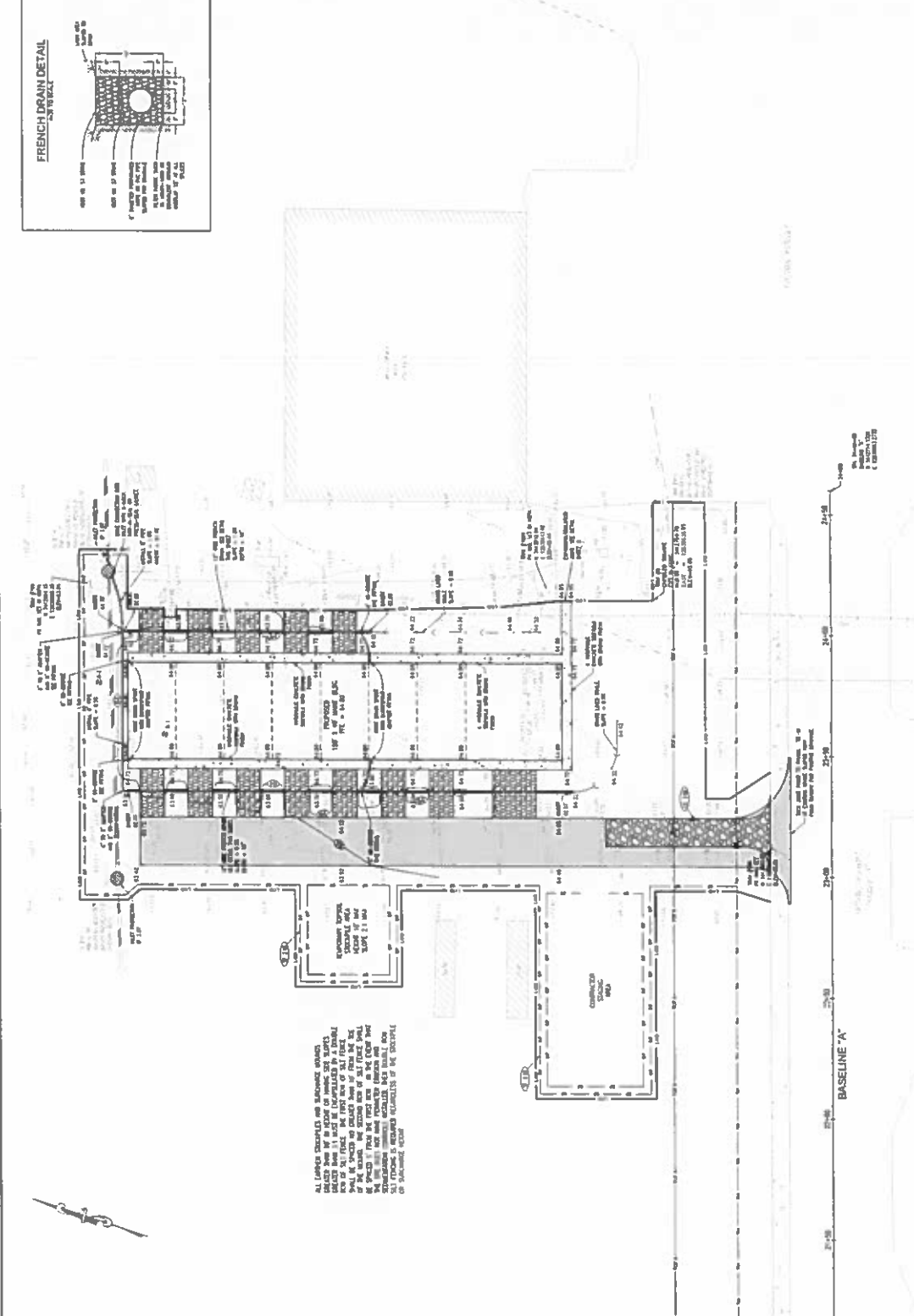
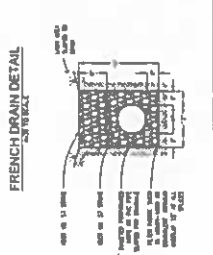

All Utilities Checked with appropriate agencies. Checked for any signs of water. All utilities shall be marked and protected in accordance with the applicable code. The contractor shall be responsible for protecting all existing utilities and services to remain on site. All utilities shall be identified by the contractor and protected by installing and maintaining all appropriate shielding and protective structures throughout the construction period.

BASELINE "A"

1" = 10'

NO.	DESCRIPTION	DATE
1		
2		
3		
4		
5		
6		
7		
8		
9		
10		
11		
12		
13		
14		
15		
16		
17		
18		
19		
20		
21		
22		
23		
24		
25		
26		
27		
28		
29		
30		
31		
32		
33		
34		
35		
36		
37		
38		
39		
40		
41		
42		
43		
44		
45		
46		
47		
48		
49		
50		

EROSION & SEDIMENT CONTROL NOTES & DETAILS
 Project No. 04-11-1001
 Revision No. 6
 Date: 04/15/2014
 Prepared by: T&B
 Checked by: T&B
 Approved by: T&B

- All temporary erosion and sediment control measures shall be installed within 10 days after construction begins.
- ... [Detailed list of 50 items covering erosion control measures, sedimentation standards, and site preparation requirements.]

- PROJECT LOCATION**
The project is located at the Suffolk Executive Airport... [Detailed description of project location and site conditions.]
- EXISTING CONDITIONS**
The site is an open area with some existing structures... [Description of existing site conditions.]
- DESIGN CONDITIONS**
The design shall be based on the following assumptions... [List of design assumptions.]
- GENERAL NOTES**
These notes shall apply to all construction... [General construction notes.]
- MANAGEMENT PLAN**
The Management Plan shall be submitted to the... [Requirements for the management plan.]
- CONSTRUCTION METHODS**
The following methods shall be used for construction... [List of construction methods.]
- VEGETATION**
All areas to be cleared shall be replanted... [Vegetation requirements.]
- EROSION CONTROL MEASURES**
Erosion control measures shall be installed... [Erosion control measures.]
- SEDIMENTATION CONTROL**
Sedimentation control measures shall be installed... [Sedimentation control measures.]
- WATER QUALITY**
Water quality shall be maintained... [Water quality requirements.]
- SOIL CONSERVATION**
Soil conservation measures shall be installed... [Soil conservation measures.]
- NOISE CONTROL**
Noise control measures shall be installed... [Noise control measures.]
- SAFETY**
Safety measures shall be installed... [Safety measures.]
- ACCESS**
Access shall be maintained... [Access requirements.]
- UTILITIES**
Utilities shall be protected... [Utilities protection.]
- ENVIRONMENTAL PROTECTION**
Environmental protection measures shall be installed... [Environmental protection measures.]
- ARCHIVE**
All construction records shall be archived... [Archiving requirements.]

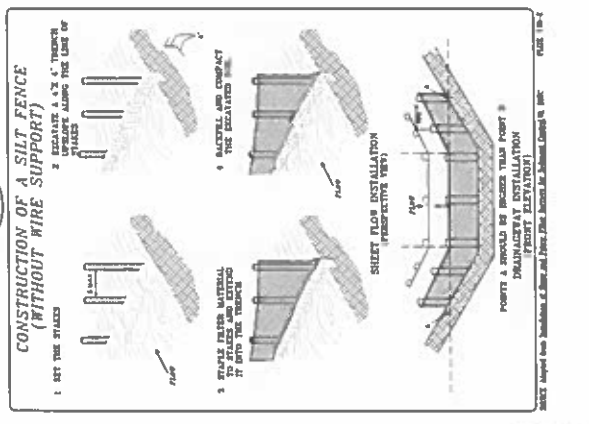
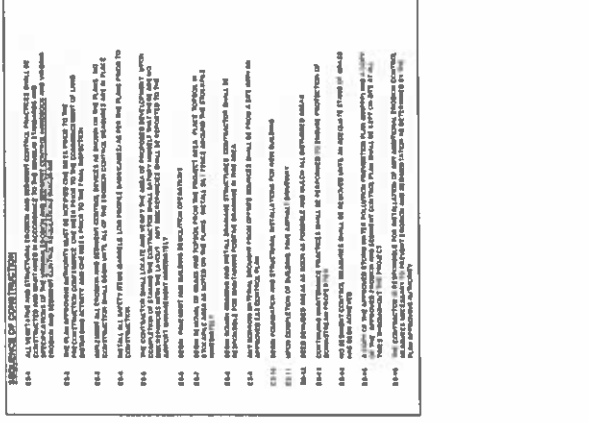
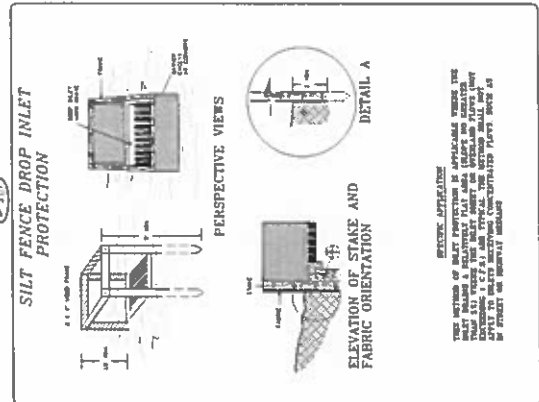
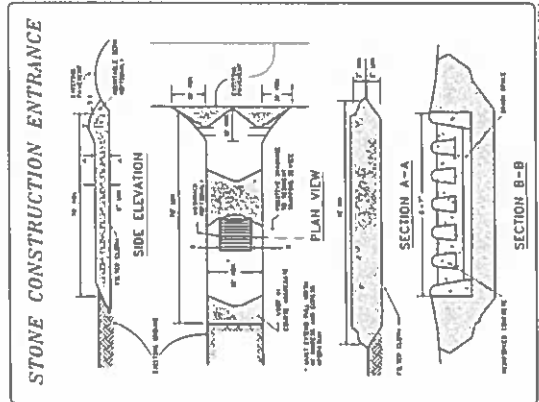

NO.	DATE	REVISIONS
1	10/13/2010	ISSUE FOR PERMITS
2	10/13/2010	ISSUE FOR PERMITS



DATE: JUNE 2014
 DRAWN BY: [Blank]
 CHECKED BY: [Blank]
 PROJECT NO.: 2013-1783
 SHEET NO.: 8
 OF 8

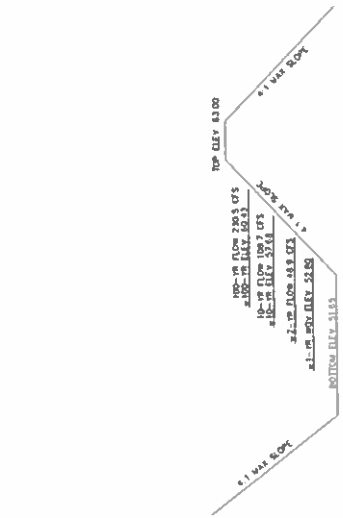
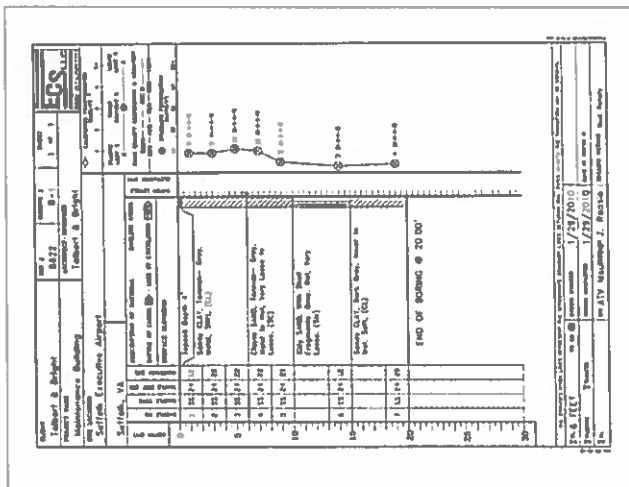
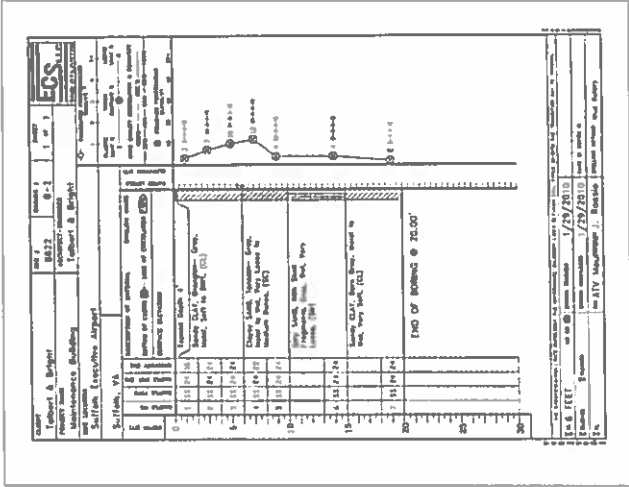

EXISTING REGIONAL BMP STORM ELEVATIONS
 NOT TO SCALE

NOTE:
 1. LOCATION OF EXISTING REGIONAL BMP IDENTIFIED ON SHEET 7 OF THIS PLAN SET
 2. RECORD DRAWING SHEET 11 OF 28 FOR THE EXISTING REGIONAL BMP IS PUBLISHED AS REFERENCE #1 TO THIS PLAN SET

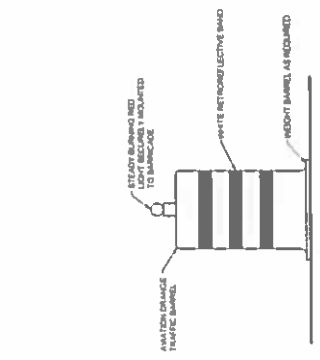

TRAFFIC BARRIAGE
 NOT TO SCALE

NOTE:
 1. BARRIAGE TO BE PROPERLY WEIGHTED TO WITHSTAND 100 MPH WINDS

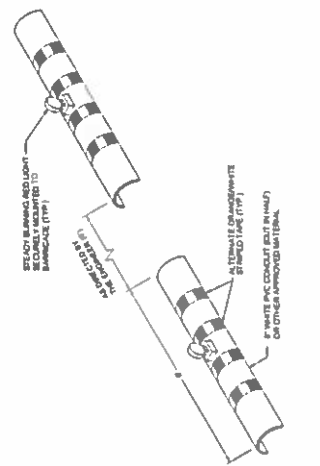

LOW PROFILE AVIATION BARRIAGE
 NOT TO SCALE

NOTE:
 1. BARRIAGE TO BE PROPERLY WEIGHTED TO WITHSTAND 100 MPH WINDS

NO.	DESCRIPTION	DATE

STORMWATER MANAGEMENT BASIN PLAN

PROJECT NO. 2011-0001
 SHEET NO. 18
 DATE: 09/08/10
 DRAWN BY: [Signature]
 CHECKED BY: [Signature]

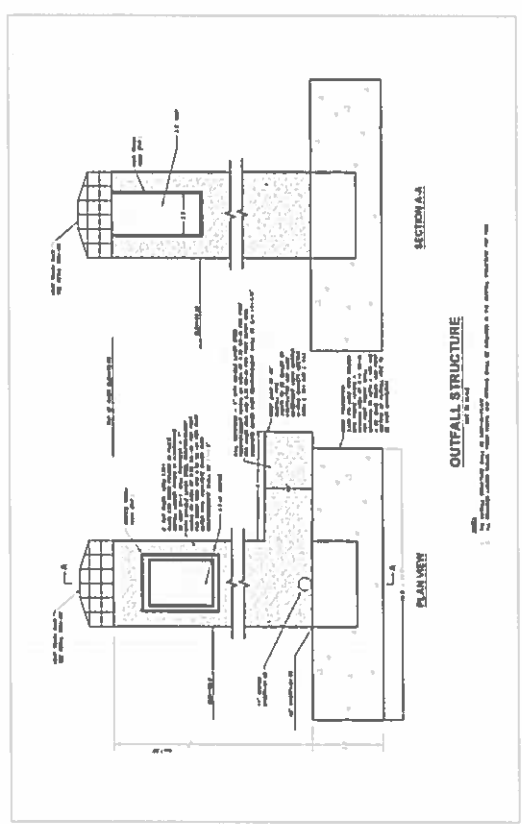
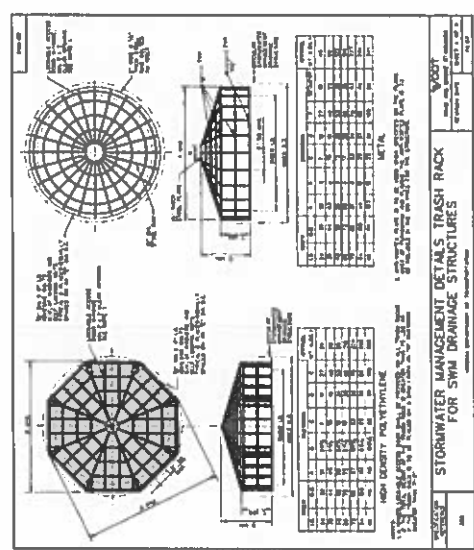
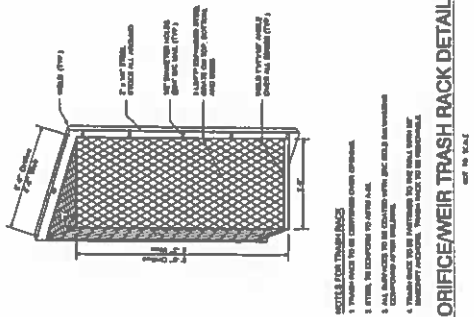

RECORD DRAWINGS
 SEPTEMBER 8, 2010

